



27 Roulston Rd, Windham NH 03087 • Phone: (603) 894-6100 • Fax: (603) 894-6161  
[cet@cettechnology.com](mailto:cet@cettechnology.com) • [www.cettechnology.com](http://www.cettechnology.com)

## UL Approved Power Transformers P241/PDP241 FEATURES

The P/PDP series is an illustration of the use of creative design applied to small power transformers. The result is a line where, for a given VA rating, size, and weight are reduced almost 50%.

- BOBBIN WOUND – Maximum Utilization of Winding Area – Space and Size Reduced.
- SPLIT BOBBIN – NON-CONCENTRIC WINDING – Lower Capacitance – Better insulation – 2500V RMS HIPOT – No need for Electro-Static Shield – High Isolation and Insulation Resistance. No Cross Overs of Primary and Secondary Leads

This series is available with single 115V or dual 115/230V primary, rated 50/60 Hz.

- UL Recognized File #E146472
- Approved to CSA 22.2 No. 66
- Class B Insulation 130°C
- Custom Versions also available.

| Size | VA  | L      | W     | H     | A     | B     | ML    | kg   |
|------|-----|--------|-------|-------|-------|-------|-------|------|
| 3    | 2.4 | 52.39  | 26.99 | 30.16 | 41.28 | 14.29 | 44.45 | 0.11 |
| 4    | 6   | 60.33  | 31.75 | 34.93 | 42.86 | 17.46 | 50.80 | 0.20 |
| 5    | 12  | 71.44  | 34.93 | 41.28 | 49.21 | 20.64 | 60.33 | 0.32 |
| 6    | 30  | 82.55  | 42.86 | 49.21 | 58.74 | 26.99 | 71.44 | 0.50 |
| 7    | 56  | 93.66  | 46.04 | 57.15 | 68.26 | 26.99 | 79.38 | 0.77 |
| 8    | 100 | 102.39 | 57.15 | 65.09 | 77.79 | 33.34 | 90.49 | 1.25 |

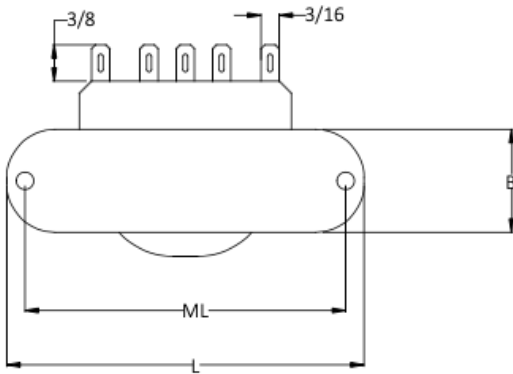
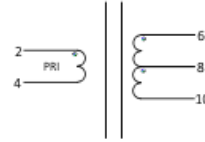
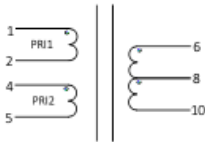
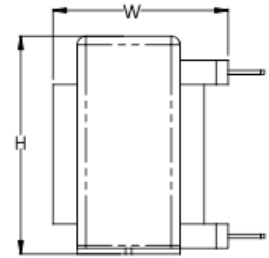
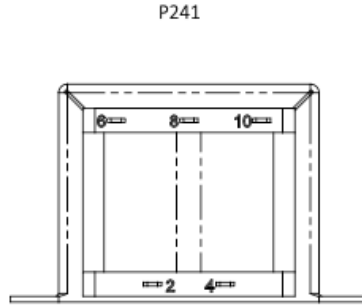
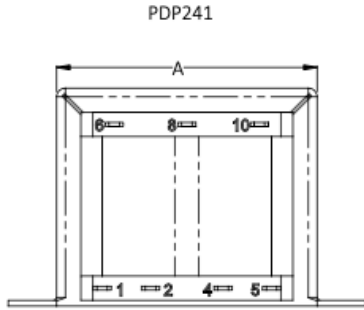

| <b>PART NUMBER</b> |                       | <b>SECONDARY RMS RATING</b> |
|--------------------|-----------------------|-----------------------------|
| <b>Single 115V</b> | <b>Dual 115V/230V</b> |                             |
| P241-3-10          |                       | 10V C.T. @ 0.25A            |
| P241-4-10          | PDP 241-4-10          | 10V C.T. @ 0.6A             |
| P241-5-10          | PDP 241-5-10          | 10V C.T. @ 1.2A             |
| P241-6-10          | PDP 241-6-10          | 10V C.T. @ 3.0A             |
| P241-7-10          | PDP 241-7-10          | 10V C.T. @ 5.0A             |
| P241-8-10          | PDP 241-8-10          | 10V C.T. @ 10A              |
| P241-3-12          |                       | 12.6V C.T. @ 0.2A           |
| P241-4-12          | PDP 241-4-12          | 12.6V C.T. @ 0.5A           |

|           |              |                   |
|-----------|--------------|-------------------|
| P241-5-12 | PDP 241-5-12 | 12.6V C.T. @ 1.0A |
| P241-6-12 | PDP 241-6-12 | 12.6V C.T. @ 2.5A |
| P241-7-12 | PDP 241-7-12 | 12.6V C.T. @ 4.0A |
| P241-8-12 | PDP 241-8-12 | 12.6V C.T. @ 8.0A |
| P241-3-16 |              | 16V C.T. @ 0.15A  |
| P241-4-16 | PDP 241-4-16 | 16V C.T. @ 0.4A   |
| P241-5-16 | PDP 241-5-16 | 16V C.T. @ 0.8A   |
| P241-6-16 | PDP 241-6-16 | 16V C.T. @ 2.0A   |
| P241-7-16 | PDP 241-7-16 | 16V C.T. @ 3.5A   |
| P241-8-16 | PDP 241-8-16 | 16V C.T. @ 6.25A  |
| P241-3-20 |              | 20V C.T. @ 0.12A  |
| P241-4-20 | PDP 241-4-20 | 20V C.T. @ 0.3A   |
| P241-5-20 | PDP 241-5-20 | 20V C.T. @ 0.6A   |
| P241-6-20 | PDP 241-6-20 | 20V C.T. @ 1.5A   |
| P241-7-20 | PDP 241-7-20 | 20V C.T. @ 2.8A   |
| P241-8-20 | PDP 241-8-20 | 20V C.T. @ 5.0A   |
| P241-3-24 |              | 24V C.T. @ 0.1A   |
| P241-4-24 | PDP 241-4-24 | 24V C.T. @ 0.25A  |
| P241-5-24 | PDP 241-5-24 | 24V C.T. @ 0.5A   |
| P241-6-24 | PDP 241-6-24 | 24V C.T. @ 1.25A  |
| P241-7-24 | PDP 241-7-24 | 24V C.T. @ 2.4A   |
| P241-8-24 | PDP 241-8-24 | 24V C.T. @ 2.0A   |
| P241-3-28 |              | 28V C.T. @ 0.085A |
| P241-4-28 | PDP 241-4-28 | 28V C.T. @ 0.2A   |
| P241-5-28 | PDP 241-5-28 | 28V C.T. @0.42A   |
| P241-6-28 | PDP 241-6-28 | 28V C.T. @ 1.1A   |
| P241-7-28 | PDP 241-7-28 | 28V C.T. @ 2.0A   |
| P241-8-28 | PDP 241-8-28 | 28V C.T. @ 3.6A   |
| P241-3-36 |              | 36V C.T. @ 0.065A |
| P241-4-36 | PDP 241-4-36 | 36V C.T. @ 0.17A  |
| P241-5-36 | PDP 241-5-36 | 36V C.T. @ 0.35A  |

|            |               |                   |
|------------|---------------|-------------------|
| P241-6-36  | PDP 241-6-36  | 36V C.T. @ 0.85A  |
| P241-7-36  | PDP 241-7-36  | 36V C.T. @ 1.5A   |
| P241-8-36  | PDP 241-8-36  | 36V C.T. @ 2.8A   |
| P241-3-48  |               | 48V C.T. @ 0.05A  |
| P241-4-48  | PDP 241-4-48  | 48V C.T. @ 1.25A  |
| P241-5-48  | PDP 241-5-48  | 48V C.T. @ 0.25A  |
| P241-6-48  | PDP 241-6-48  | 48V C.T. @ 0.63A  |
| P241-7-48  | PDP 241-7-48  | 48V C.T. @ 1.2A   |
| P241-8-48  | PDP 241-8-48  | 48V C.T. @ 2.0A   |
| P241-3-56  |               | 56V C.T. @ 0.045A |
| P241-4-56  | PDP 241-4-56  | 56V C.T. @ 0.11A  |
| P241-5-56  | PDP 241-5-56  | 56V C.T. @ 0.22A  |
| P241-6-56  | PDP 241-6-56  | 56V C.T. @ 0.54A  |
| P241-7-56  | PDP 241-7-56  | 56V C.T. @ 1.0A   |
| P241-8-56  | PDP 241-8-56  | 56V C.T. @ 1.8A   |
| P241-3-120 |               | 120V C.T. @ 0.02A |
| P241-4-120 | PDP 241-4-120 | 120V C.T. @ 0.05A |
| P241-5-120 | PDP 241-5-120 | 120V C.T. @ 0.1A  |
| P241-6-120 | PDP 241-6-120 | 120V C.T. @ 0.25A |
| P241-7-120 | PDP 241-7-120 | 120V C.T. @ 0.5A  |
| P241-8-120 | PDP 241-8-120 | 120V C.T. @ 0.85A |